

ROCKET M3: 3.3-3.7GHz Hi Power 2x2 MIMO AirMax TDMA BaseStation

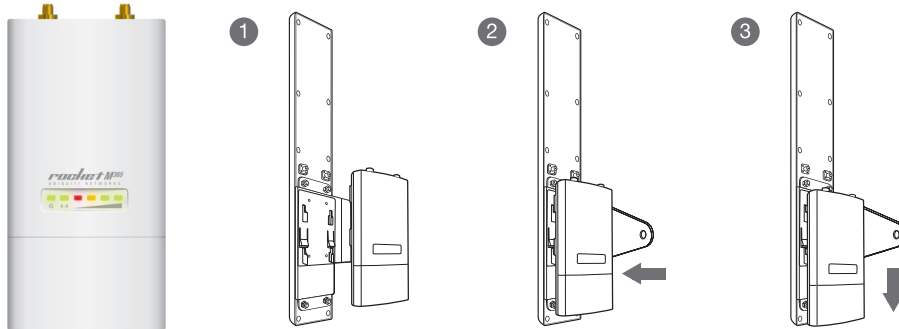

airMAX
MIMO TDMA Protocol

COMPATIBLE ANTENNAS

AirMax Sector 3G-18-120
Rocket Dish 3G-26

SYSTEM INFORMATION

Processor Specs	Atheros MIPS 24KC, 400MHz
Memory Information	64MB SDRAM, 8MB Flash
Networking Interface	1 X 10/100 BASE-TX (Cat. 5, RJ-45) Ethernet Interface

REGULATORY / COMPLIANCE INFORMATION

RoHS Compliance	YES
-----------------	-----

OPERATING FREQUENCY 3300MHz-3700MHz

TX POWER SPECIFICATIONS				RX SPECIFICATIONS			
	DataRate	Avg. TX	Tolerance		DataRate	Sensitivity	Tolerance
AirMax	MCS0	25 dBm	+/-2dB	Airmax	MCS0	-94 dBm	+/-2dB
	MCS1	25 dBm	+/-2dB		MCS1	-93 dBm	+/-2dB
	MCS2	25 dBm	+/-2dB		MCS2	-90 dBm	+/-2dB
	MCS3	25 dBm	+/-2dB		MCS3	-89 dBm	+/-2dB
	MCS4	24 dBm	+/-2dB		MCS4	-86 dBm	+/-2dB
	MCS5	23 dBm	+/-2dB		MCS5	-83 dBm	+/-2dB
	MCS6	22 dBm	+/-2dB		MCS6	-77 dBm	+/-2dB
	MCS7	20 dBm	+/-2dB		MCS7	-74 dBm	+/-2dB
	MCS8	25 dBm	+/-2dB		MCS8	-93 dBm	+/-2dB
	MCS9	25 dBm	+/-2dB		MCS9	-91 dBm	+/-2dB
	MCS10	25 dBm	+/-2dB		MCS10	-89 dBm	+/-2dB
	MCS11	25 dBm	+/-2dB		MCS11	-87 dBm	+/-2dB
	MCS12	24 dBm	+/-2dB		MCS12	-84 dBm	+/-2dB
	MCS13	23 dBm	+/-2dB		MCS13	-79 dBm	+/-2dB
	MCS14	22 dBm	+/-2dB		MCS14	-78 dBm	+/-2dB
MCS15	20 dBm	+/-2dB	MCS15	-75 dBm	+/-2dB		

PHYSICAL / ELECTRICAL / ENVIRONMENTAL

Enclosure Size	16cm length x 8cm width x 3cm height
Weight	0.5 kg
RF Connector	2x RPSMA (Waterproof)
Enclosure Characteristics	Outdoor UV Stabilized Plastic
Mounting Kit	Pole Mounting Kit included
Max Power Consumption	6.5 Watts
Power Supply	24V, 1A POE Supply Included
Power Method	Passive Power over Ethernet (pairs 4,5+; 7,8 return)
Operating Temperature	-30C to 75C
Operating Humidity	5 to 95% Condensing
Shock and Vibration	ETSI300-019-1.4